

CF Series Dewar Flasks

Liquid Nitrogen, Liquid Oxygen, Liquid Natural Gas and Liquid Argon storage

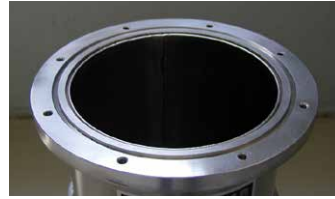
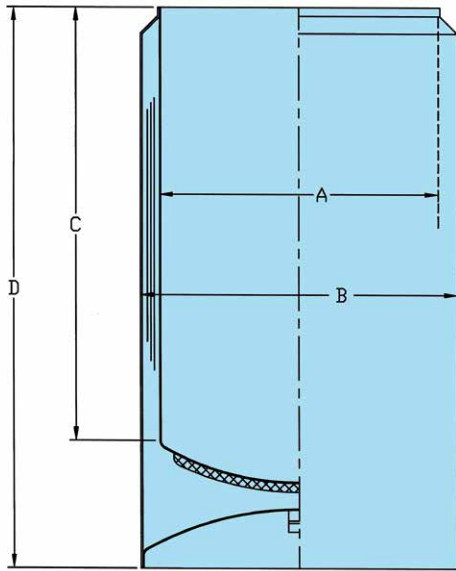

**Optional:
Flanged Top,
Custom Cover Plate**

[MORE OPTIONS AVAILABLE](#)

Model	"A" Inside Diameter (Inches)	"B" Outside Diameter (Inches)	"C" Inner Depth (Inches)	"D" Overall Height (Inches)	Gross Capacity (Liters)	Loss Rate (Liters/ Hr)	Liters/ Inch
CF4515	4.46	5.07	15	18	3.8	0.093	0.25
CF4524	4.46	5.07	24	27	6.1	0.074	0.25
CF4536	4.46	5.07	36	39	9.2	0.065	0.25
CF612	5.96	6.6	12	16	5.5	0.143	0.46
CF618	5.96	6.6	18	22	8.2	0.114	0.46
CF624	5.96	6.6	24	28	11.0	0.099	0.46
CF636	5.96	6.6	36	40	16.4	0.086	0.46
CF7512	7.46	8.1	12	16	8.6	0.178	0.72
CF7518	7.46	8.1	18	22	12.9	0.140	0.72
CF7524	7.46	8.1	24	28	17.2	0.125	0.72
CF7536	7.46	8.1	36	40	25.7	0.108	0.72
CF8512	8.46	9.1	12	16	11.0	0.205	0.92
CF8518	8.46	9.1	18	22	16.6	0.163	0.92
CF8524	8.46	9.1	24	28	22.1	0.142	0.92
CF8536	8.46	9.1	36	40	33.0	0.123	0.92
CF9512	9.46	10.13	12	16	13.8	0.230	1.15
CF9518	9.46	10.13	18	22	20.1	0.183	1.15
CF9524	9.46	10.13	24	28	27.6	0.160	1.15
CF9536	9.46	10.13	36	40	41.4	0.138	1.15
CF10518	10.43	11.13	18	23	25.9	0.200	1.44
CF10524	10.43	11.13	24	29	34.5	0.176	1.44
CF10536	10.43	11.13	36	41	51.8	0.153	1.44
CF1218	11.95	12.625	18	23	33.1	0.242	1.84
CF1224	11.95	12.625	24	29	44.2	0.211	1.84
CF1236	11.95	12.625	36	41	66.2	0.183	1.84
CF1248	11.95	12.625	48	53	88.3	0.163	1.84
CF1418	13.93	16	18	23	44.9	0.420	2.49
CF1424	13.93	16	24	29	59.9	0.340	2.49
CF1436	13.93	16	36	41	89.8	0.265	2.49
CF1448	13.93	16	48	53	119.7	1.790	2.49

Model	"A" Inside Diameter (Inches)	"B" Outside Diameter (Inches)	"C" Inner Depth (Inches)	"D" Overall Height (Inches)	Gross Capacity (Liters)	Loss Rate (Liters/ Hr)	Liters/ Inch
CF1618	15.93	18	18	23	58.7	0.478	3.26
CF1624	15.93	18	24	29	78.3	0.394	3.26
CF1636	15.93	18	36	41	117.4	0.300	3.26
CF1648	15.93	18	48	53	156.5	0.205	3.26
CF1818	17.93	20	18	23	74.4	0.420	4.13
CF1824	17.93	20	24	29	99.2	0.353	4.13
CF1836	17.93	20	36	41	148.8	0.278	4.13
CF1848	17.93	20	48	53	198.3	0.230	4.13
CF2024	19.9	22	24	29	122.1	0.392	5.10
CF2036	19.9	22	36	41	183.2	0.310	5.10
CF2042	19.9	22	42	47	213.8	0.277	5.10
CF2048	19.9	22	48	53	244.0	0.257	5.10
CF2224	21.9	24	24	29	147.9	0.432	6.20
CF2236	21.9	24	36	41	221.9	0.341	6.20
CF2242	21.9	24	42	47	258.9	0.313	6.20
CF2248	21.9	24	48	53	295.6	0.283	6.20
CF2424	23.9	26	24	29	176.2	0.472	7.40
CF2436	23.9	26	36	41	264.2	0.372	7.40
CF2442	23.9	26	42	47	308.3	0.342	7.40
CF2448	23.9	26	48	53	352.4	0.309	7.40
CF2624	25.9	28	24	30	155.2	0.861	8.60
CF2636	25.9	28	36	42	310.4	0.562	8.60
CF2642	25.9	28	42	48	362.1	0.514	8.60
CF2648	25.9	28	48	54	413.6	0.452	8.60
CF2836	27.9	30	36	42	360.1	0.610	10.00
CF2842	27.9	30	42	48	420.2	0.554	10.00
CF2848	27.9	30	48	54	480.1	0.488	10.00
CF3036	29.73	32	36	42	408.9	0.650	11.40
CF3042	29.73	32	42	48	477.1	0.593	11.40
CF3048	29.73	32	48	54	545.5	0.533	11.40

- NOTE:** 1. Inner depth indicates the depth at full diameter; depth to center is slightly greater.
 2. Loss rate is on average value assuming the dewar was run from full to empty with an insulated lid. Instantaneous values are dependent on liquid level.

3. When ordering, please specify whether for use with dry ice, liquid gas or high temperature.
 4. Depths as well as diameters can be altered to individual requirements with corresponding price adjustments.